

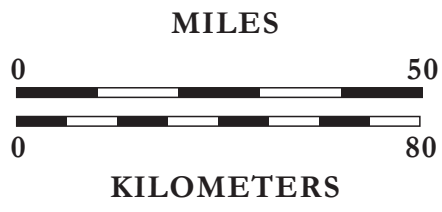

# NEVADA

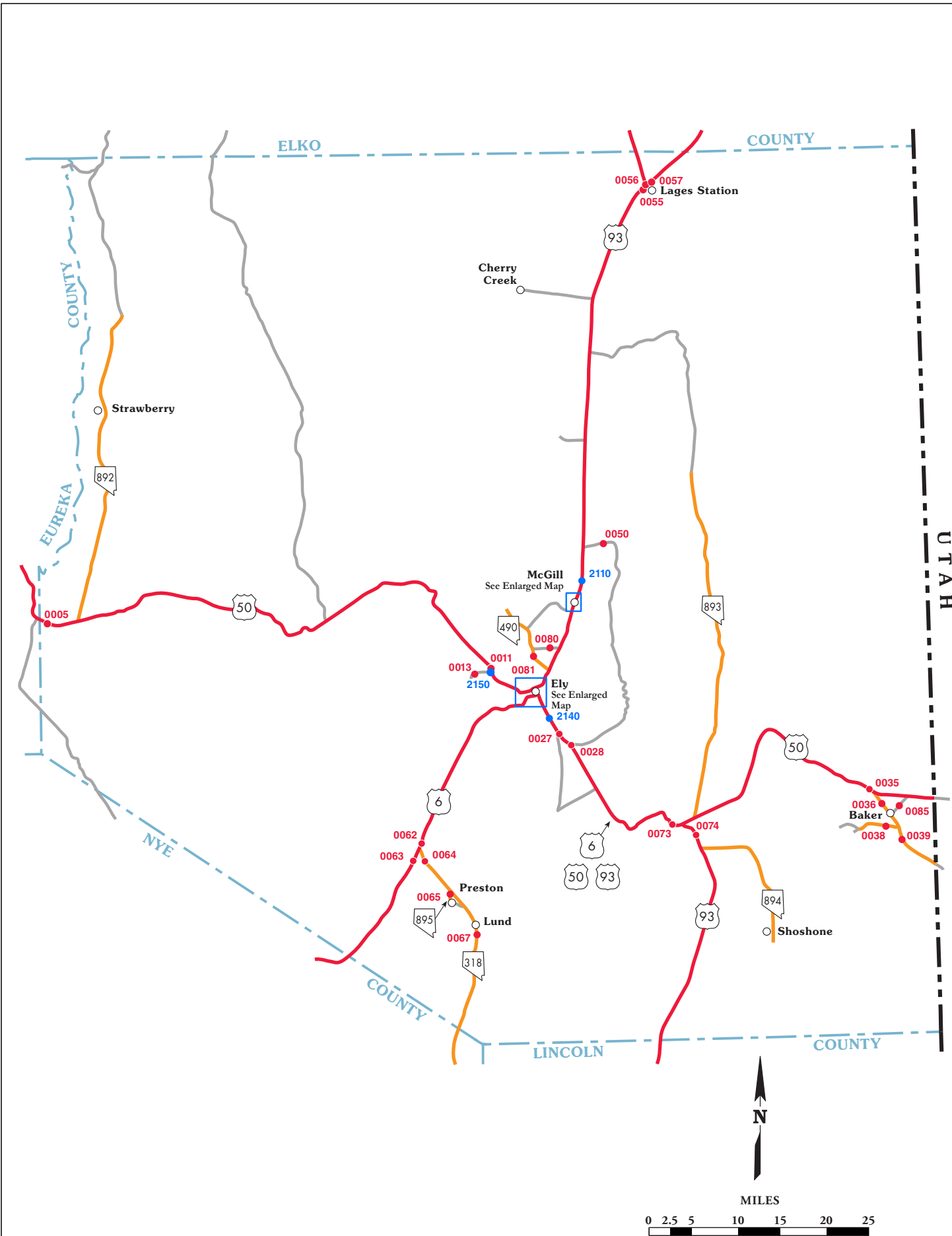



# White Pine County

## White Pine (033)

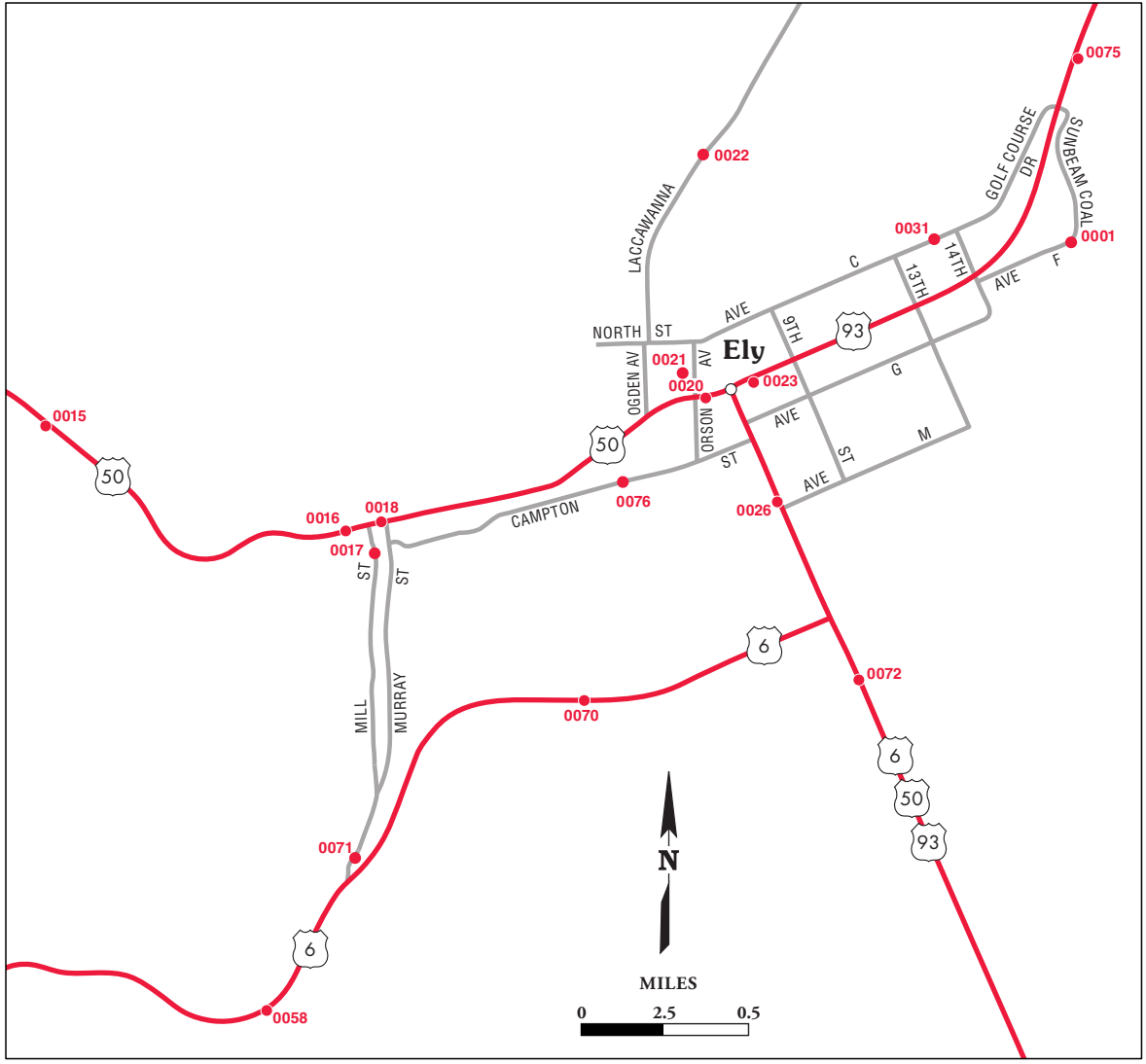

**Ely Area**  
 White Pine (033)

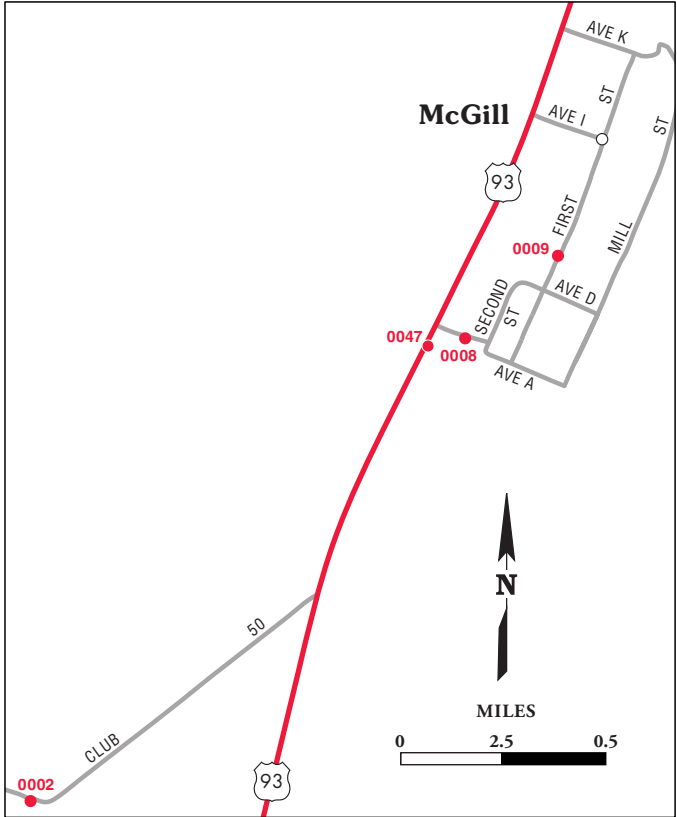

**McGill Area**  
 White Pine (033)

**State of Nevada Department of Transportation  
Annual Average Daily Traffic Count Stations**

County Name: White Pine

Station	Route/Location	2014 AADT	2015 AADT	2016 AADT	2017 AADT	2018 AADT	2019 AADT	2020 AADT	2021 AADT	2022 AADT	2023 AADT
0330001	Ave 'F', 175ft W of Rodeo Dr	150	150	180	120	140	160	140	130	130	150
0330002	Power Line Rd, .9 mi W of US93 S of McGill	150	150	140	120	130	140	160	190	140	120
0330005	US50, 1.2 mi E of Fish Creek Rd to Duckwater	680	600	650	590	680	670	530	710	650	640
0330008	Ave A, 500ft E of US93 in McGill	400	450	370	380	370	320	320	360	370	330
0330009	1st St, 165ft N of Ave E	300	300	290	300	250	260	220	220	200	220
0330011	Ruth-Kimberly Rd, 600ft S of US50	1500	1400	1200	1200	1300	1350	1400	1500	1600	1200
0330013	Kimberly Branch Rd, 1.9 mi S of US50	750	800	570	630	640	650	850	930	940	720
0330015	US50, 3.6 mi E of Ruth Rd W of the Kennecott Copper RxR overpass W of Ely	2100	2200	2300	2100	2250	2300	2300	2050	2150	2100
0330016	US50, 85ft W of Mill St	3100	3200	2800	3500	3300	2700	3100	2850	2800	2700
0330017	Mill St, 120ft S of US50 (Aultman St)	1300	1300	1300	1300	1250	1200	1150	1600	1300	1200
0330018	US50, 65ft W of 4th St	4300	4400	4100	5300	5500	4150	4150	3950	3900	4150
0330020	US50, 400ft W of US93 jct	8000	8200	8000	9000	8550	8700	8400	9100	7200	6950
0330021	Center St, 270ft E of Parker St	100	100	100	110	120	120	100	110	100	100
0330022	Lackawanna Rd, at the RxR tracks	850	900	830	830	860	850	770	830	700	700
0330023	US93, 200ft N of US50 (Aultman St)	10500	11000	11000	11000	11300	10400	10000	10900	10500	10000
0330026	Great Basin Blvd, 110ft N of Ave 'M'	9600	9700	10000	10000	11600	11800	11400	12400	10100	9300
0330027	County Rd to the Ward Charcoal Ovens State Park, 200ft S/W of US6/US50/US93	70	100	120	100	110	110	110	160	120	120

Color indicates that this AADT value is estimated

		2014	2015	2016	2017	2018	2019	2020	2021	2022	2023
Station	Route/Location	AADT	AADT	AADT	AADT	AADT	AADT	AADT	AADT	AADT	AADT
0330028	Steptoe Creek Forest Camp (Cave Lake Turn Off), .2 mi E of U50	150	200	150	160	230	160	160	190	190	150
0330031	Ave 'C', 600ft E of 15th St	300	300	250	260	380	380	430	650	690	590
0330035	US50, .2 mi E of mp WP72	500	600	620	590	610	560	670	730	570	580
0330036	SR487, Baker Rd, .3 mi S of US6/US50	300	300	270	310	350	360	350	370	320	320
0330038	SR488, Lehman Caves Rd, 1.5 mi W of SR487 in Baker	400	350	440	450	470	490	540	590	540	540
0330039	SR487, Baker Rd, 1.2 mi S of SR488 to Lehman Caves	150	150	210	160	170	270	230	260	250	220
0330047	US93, 150ft S of Ave A	3500	4100	3800	4100	4250	3600	4300	4750	4600	4300
0330050	Duck Creek Rd, 200ft E of US93	90	90	100	100	110	100	130	170	110	110
0330055	US93, .5 mi S of US93A (Lages Jct)	1200	1800	1700	1900	1900	2100	1850	2200	2150	2100
0330056	US93, .3 mi N of US93A (Lages Jct)	1300	1500	1300	1700	1500	1550	1600	1850	2400	2200
0330057	US93A, .2 mi N of US93 (Lages Jct)	450	500	400	470	480	450	340	520	620	580
0330058	US6, .45 mi W of Murray St	1800	2000	2100	2800	2300	2300	2250	2250	2200	2200
0330062	US6, .1 mi E of WP16	1700	1900	1800	1800	2100	2150	2050	2250	2700	2600
0330063	US6, .2 mi W of SR318 to Preston & Lund	300	300	470	480	410	470	440	460	450	480
0330064	SR318, Sunnyside Rd, 565ft S of US6	1500	1600	1500	1900	1700	1800	1850	1850	1750	1750
0330065	SR895, Preston Spur, .2 mi W of SR318 in Preston	80	80	80	70	80	80	80	90	60	60
0330070	US6, .7 mi W of US50	2300	2400	2300	3200	3100	3150	3050	3250	3000	3100
0330071	Murray St, 385ft N/W of US6	750	700	780	810	740	690	690	920	830	760
0330072	US6, .2 mi S of the US6 & US93 jct.	3600	3800	3700	3500	3600	3400	3600	3900	3750	3600
0330073	US50, 620ft W of US6/US50 with US93 at Major Woods	750	900	950	900	830	870	1050	1150	970	970

Color indicates that this AADT value is estimated

		2014	2015	2016	2017	2018	2019	2020	2021	2022	2023
Station	Route/Location	AADT	AADT	AADT	AADT	AADT	AADT	AADT	AADT	AADT	AADT
0330074	US93, .4 mi S of US6/US50 at Majors	350	300	420	390	360	330	310	480	500	480
0330075	US93, .1 mi N of US93 mp 55 E	5700	5300	5300	5600	5850	5850	5450	5600	5450	5350
0330076	Campton St, 170ft W of Winter Rd	1400	1500	1500	1900	1950	1800	940	1350	1500	1350
0330080	SR490, Prison Rd, 1.5 mi W of US93 Jct	350	400	450	460	440	430	420	460	410	420
0330081	SR490, Prison Rd, .5 mi N of Lackawanna Rd	750	900	950	940	1000	1050	1000	900	840	800
0330085	Baker Cut-off Rd, 1.3 mi S of US50 (1.5 mi E of SR487)	100	100	110	110	150	140	140	150	160	160

Color indicates that this AADT value is estimated