

S T O R E Y C O U N T Y

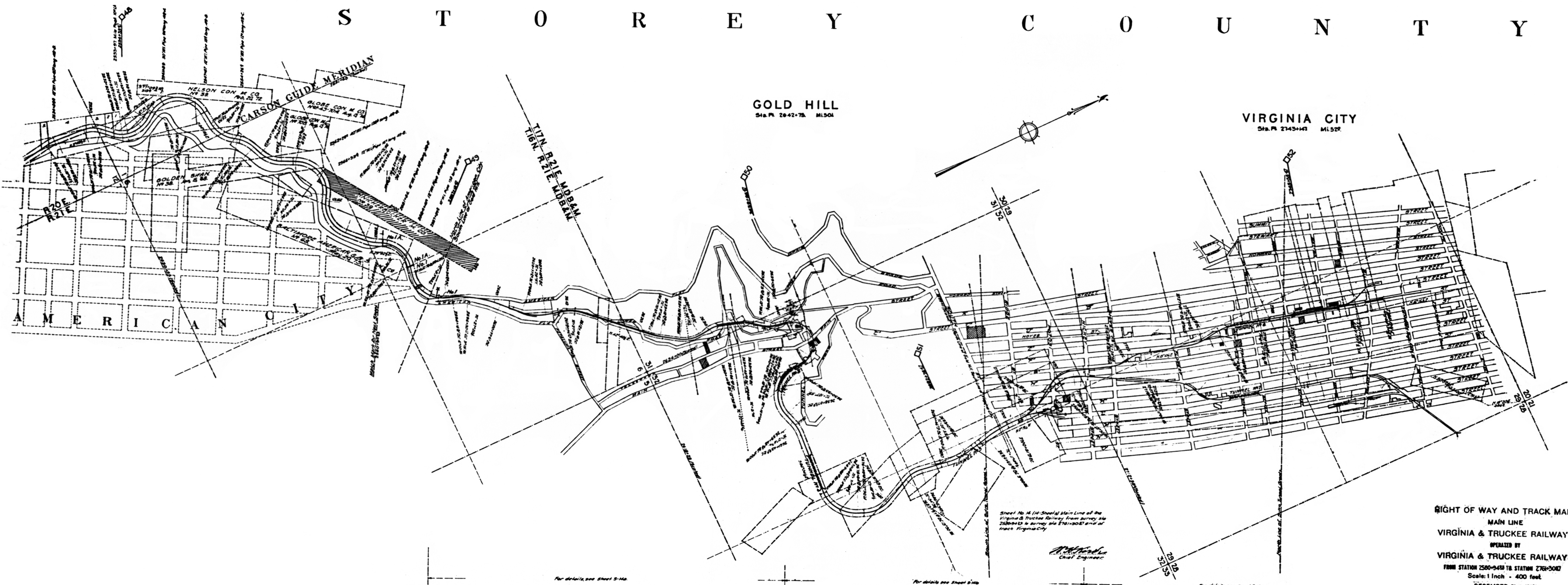

GOLD HILL
Sta. P. 2642+75. M. 501

VIRGINIA CITY
Sta. P. 2743+43. M. 522

Sheet No. 4 (of Sheet) Main Line of the
Virginia & Truckee Railway from survey No.
258643 is survey No. 271902 and at
track Virginia City

R. H. H. H.
Chief Engineer

RIGHT OF WAY AND TRACK MAP
MAIN LINE
VIRGINIA & TRUCKEE RAILWAY
OPERATED BY
VIRGINIA & TRUCKEE RAILWAY
FROM STATION 2500+45 TO STATION 2761+00
Scale: 1 Inch = 400 feet
DECEMBER 31st, 1918
OFFICE OF CHIEF ENGINEER
CARSON CITY, NEVADA

V-1
14