

CARSON CITY
NEVADA

Sta. P. 1635+617 Mi. 312

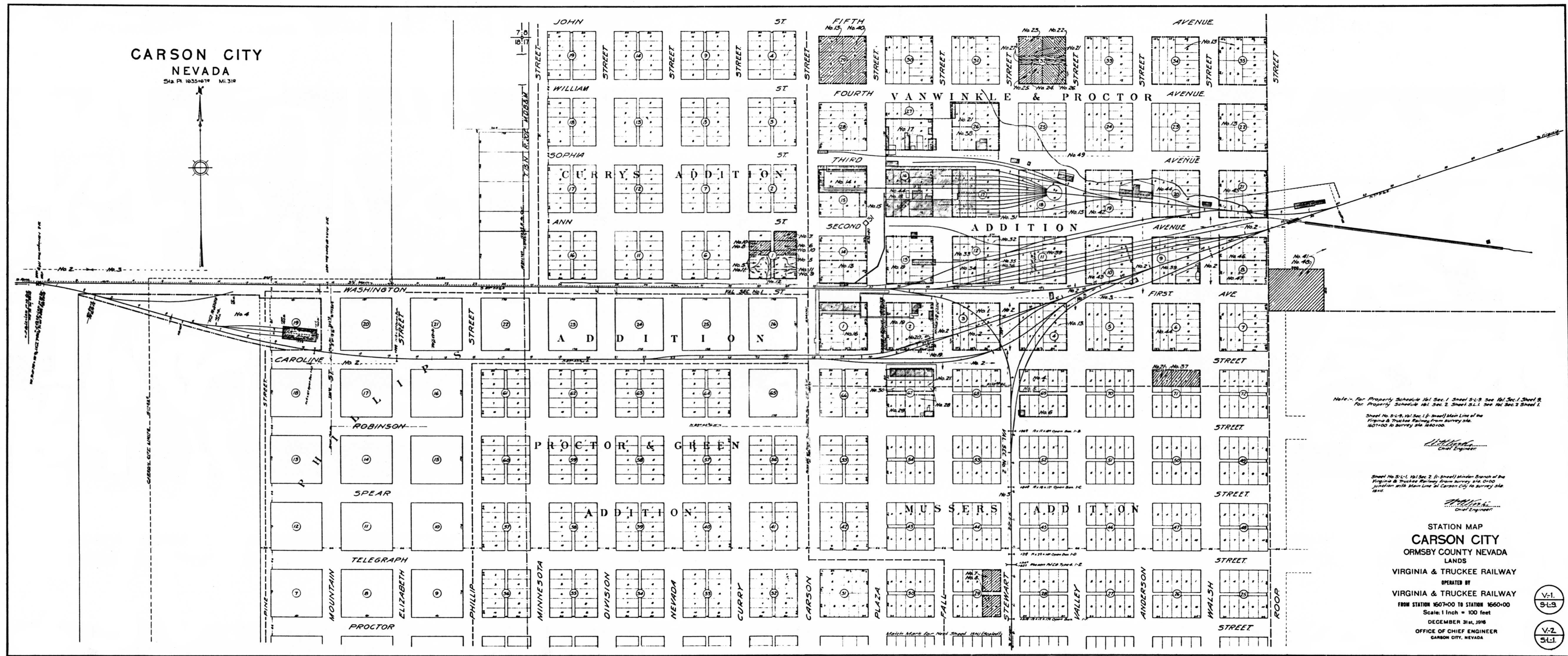

Note: For Property Schedule 1st Sec. 1 Sheet 3-L-9 See 1st Sec. 1 Sheet 8
For Property Schedule 1st Sec. 2 Sheet 3-L-1 See 1st Sec. 2 Sheet 1.
Sheet No. 3-L-9, 1st Sec. 1, 2nd Small Main Line of the
Virginia & Truckee Railway from survey sta.
1607+00 to survey sta. 1640+00.

STATION MAP
CARSON CITY
ORMSBY COUNTY NEVADA
LANDS

VIRGINIA & TRUCKEE RAILWAY
OPERATED BY
VIRGINIA & TRUCKEE RAILWAY
FROM STATION 1607+00 TO STATION 1660+00
Scale: 1 Inch = 100 feet
DECEMBER 31st, 1918
OFFICE OF CHIEF ENGINEER
CARSON CITY, NEVADA

V-1
3-L-9
V-2
3-L-1