

**DRAFT**

Transverse Mercator Projection 1983  
 Mount Diablo Base and Meridian (NVD)  
 20,000 Meter Universal Transverse  
 Mercator Grid (-) Zone 11  
 North American Datum 1983  
 Nevada Department of Transportation  
 www.ndot.gov  
 Note: These maps only contain the RS2477  
 Roads submitted by the counties. NDOT  
 does not make any determination on the  
 character of these roads with respect to  
 their legal designation as a RS2477 roadway.  
 Note: NDOT makes no determination with  
 regard to legal status of any road not  
 maintained by NDOT.

- Interstate
- Federal Highway
- State Highway
- State Capital
- County Seat
- City/Town
- Site
- Interstate with Interchange
- Federal Highway
- State Highway
- County or Local Road
- RS 2477 Road
- Other Road
- Railroad
- State Line
- County Line
- Township or Range Line
- Section Line
- Peak
- Summit or Pass

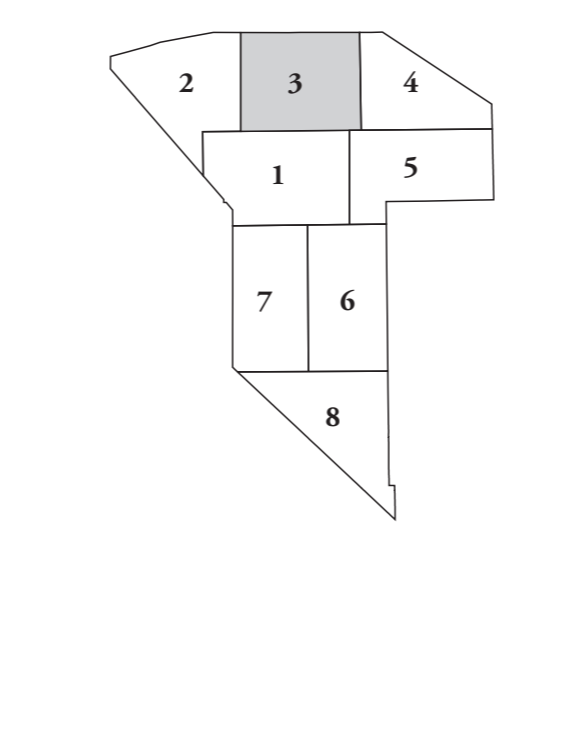

**GENERAL HIGHWAY MAP**  
**NYE COUNTY**  
**NEVADA**  
 June, 2016  
 (revised 2021)

Prepared by and for sale at:  
**NEVADA DEPARTMENT OF TRANSPORTATION**  
 Location Division, Cartography Section  
 1263 South Stewart Street  
 Carson City, Nevada 89712

In cooperation with the  
**U.S. Department of Transportation**  
 Federal Highway Administration



**STEVE SISOLAK**  
 Governor



**KRISTINA SWALLOW, P.E.**  
 Director

Match Line To Sheet 2

Match Line To Sheet 4

Match Line To Sheet 1

Match Line To Sheet 5